



ToughTek™ S340e

Stucco and EIFS Pump



Grab the power of ToughTek Stucco Pumps and get done sooner

- One pump does it all – from air/water-resistive barrier materials to base coats to finish coats
- Piston pump technology easily handles stucco and EIFS materials
- Electric operation – plugs into standard wall outlet
- Compact and lightweight – fits in your pickup truck
- Easy to use, easy to maintain

PROVEN QUALITY. LEADING TECHNOLOGY.

Bringing Innovation to the Way You Work

ToughTek Pumps – a breakthrough for stucco and EIFS contractors

Whether it's stucco or EIFS materials, the Graco® ToughTek S340e Stucco Pump easily handles base coats, finish coats – even air/water-resistive barrier materials – and delivers them with a smooth, steady flow.

Boost your productivity

Hand troweling stucco and EIFS materials is time-consuming and labor intensive. With the ToughTek S340e Stucco Pump, you save time, speed up the process and increase your profits by spraying and finish-troweling materials instead of using the traditional hawk and trowel method.

Engineered with piston pump technology, ToughTek Pumps deliver materials through long hose lengths – which helps you spray longer and farther to get the job done sooner. You can spend more time spraying and less time moving your equipment around the job site.

Easy to operate

Designed for simple, intuitive operation, your crew will be up and running in no time.

- Plug and play – the ToughTek S340e pump plugs into a standard 120V wall outlet – or an appropriately-sized generator
- Variable speed control – dial in the exact speed needed
- Optional remote control on/off switch – lets you start or stop the pump from the applicator

Compact, portable and easy to move

The ToughTek S340e Stucco Pump's compact design and small footprint makes it easy to transport into the jobsite. It's lightweight and easily lifted by two people. ToughTek Stucco Pumps easily fit into tight spaces so you can spray with ease.

Save money with overall durability

The ToughTek Stucco Pump's durable piston pump stands up to highly abrasive stucco and EIFS materials. Its quick knockdown design makes maintenance fast and easy.

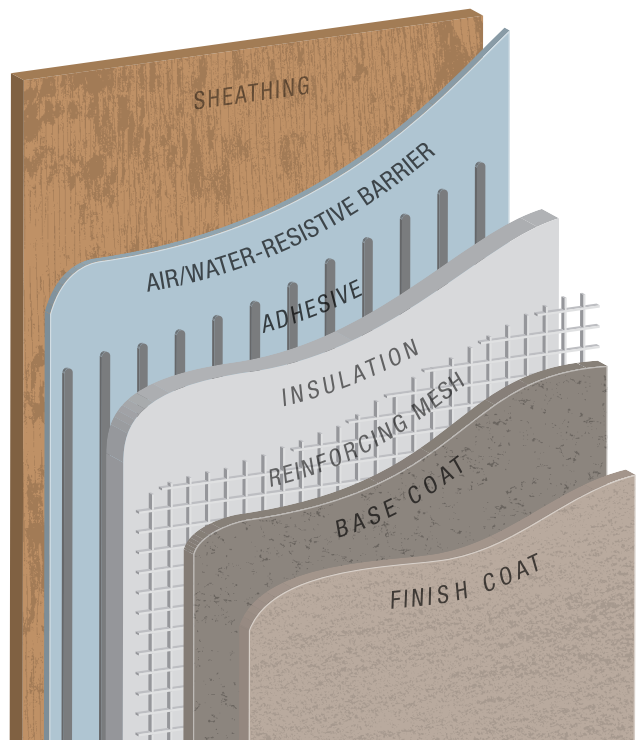

For EIFS applications, the ToughTek S340e Stucco Pump handles air/water-resistive barriers, EIFS base coat and finish coat.

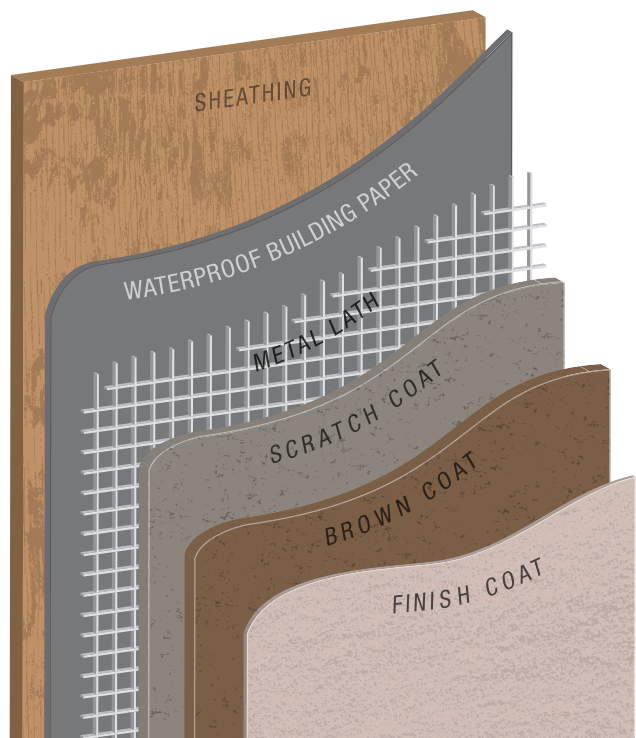

For stucco applications, the ToughTek S340e Stucco Pump handles scratch coat, brown coat and finish coat.

Low Power Requirements

- Plugs into standard 120V wall outlet
- No electrician or rewiring needed

Compact and Portable

- Easy to move

Easy to Clean Hopper

- Rugged polyethylene construction
- 20 gal (76 L) capacity

Hose Cam and Groove Connection

- For fast, easy assembly

Quick-knockdown Pump Lower

- Designed to pump stucco and EIFS materials
- Fast and easy maintenance

Variable Speed

- Dial in the exact speed needed, from low to high volume output

Optional Remote On/Off Switch

- Start or stop the pump at the applicator

Flat Proof Tires

- Withstand the worst jobsite debris

Tool-less Hopper Removal

- Disconnects in seconds to clean

Ordering Information and Technical Specifications

ToughTek S340e Stucco Pumps — All S340e units include material hopper

25A300	S340e bare, 120V, 15A, 1-ph
25A302	S340e bare, 120V, 15A, 1-ph with remote on/off switch
25A218	Stucco Kit: includes 1.5 in x 25 ft (7.6 m) hose, 1.25 in x 25 ft (7.6 m) hose and Stucco Pole Applicator (for use with stucco base coats, scratch coats and brown coats)
25A219	EIFS and Fine Finish Kit: includes 1.25 in x 25 ft (7.6 m) hose, 1 in x 10 ft (3 m) hose and HTX Applicator (for use with EIFS base coats, finish coats and fluid-applied air/water-resistive barriers)

Parts and Accessories

17G554	340e remote switch kit
25A214	Hose, 1.5 in x 25 ft (7.6 m), 750 psi (52 bar) max working pressure
25A215	Hose, 1.25 in x 25 ft (7.6 m), 750 psi (52 bar) max working pressure
25A216	Hose, 1.0 in x 10 ft (3 m), 1000 psi (69 bar) max working pressure
17G552	Hose, 1.5 in x 50 ft (15 m), 750 psi (52 bar) max working pressure
17G551	Hose, 1.25 in x 50 ft (15 m), 750 psi (52 bar) max working pressure
17G550	Hose, 1 in x 25 ft (7.6 m), 1000 psi (69 bar) max working pressure
17G767	Hose adapter (connects 1 in hose to 1.25 or 1.5 in hose)
25A466	Outlet check valve (for use with air/water-resistive barriers)
248515	Cleanout balls for 1 in hose, 30 mm, 5-pack
25A227	Cleanout balls for 1.25 in hose, 40 mm, 5-pack
25A228	Cleanout balls for 1.5 in hose, 45 mm, 5-pack

Recommended Repair Parts

25A233	Pump rebuild kit (all soft seals and check balls)
25A467	Ball check kit; includes inlet ball (15H833) and piston ball (176798)
17H193	Pump inlet elbow
17H197	Remote On/Off Switch with 100 ft (30 m) cable

Technical Specifications

Pump type	2-ball piston
Max working pressure	600 psi (41 bar, 4.1 MPa)
Max output (bags/hour)*	Up to 40 bags/hour (pre-blended material)
Max output**	6.5 gpm (24 lpm)
Volume control	Variable
Max hose length	100 ft (30.5 m) †
Hopper capacity	20 gal (76 L)
Hopper opening (W x D)	22.5 x 14 in (57 x 36 cm)
Hopper/filling height	26 in (66 cm)
Pump outlet size	1.5 in cam groove (m)
Dimensions (L x W x H)	45.5 x 24 x 38 in (116 x 61 x 97 cm)
Weight	210 lb (95 kg) (without hose and applicator)
Chemical compatibility	Water based materials
Wetted parts	SST, aluminum, plated steel, PTFE, UHMWPE, LLDPE, urethane
Remote on/off switch	Optional
Manual	3A3437A

* Tested with pre-blended base coat stucco. Performance will vary based on material, mix consistency, hose size and other factors. Check with material suppliers or contact your Graco distributor for a demonstration. ** Flow rate based on test with water. Performance will vary depending on material and hose length. † Hose length comprised of 1.5 in x 75 ft (22.9 m) and 1.25 in x 25 ft (7.6 m)

Contact us today!

For more information, e-mail toughtek@graco.com,
call 877-844-7226 or visit us online at www.graco.com.

©2015-2016 Graco Inc. ELECTRONIC ONLY 349513 Rev. B 3/16 All written and visual data contained in this document are based on the latest product information available at the time of publication. Graco reserves the right to make changes at any time without notice. All other brand names or marks are used for identification purposes and are trademarks of their respective owners.

